

Coaxial Adapter 7-16 male, right angle - female

Coaxial Adapter, 7-16 Male/Female
Right Angle



Technical Features

STRUCTURE

Product Line	Coaxial Cable Components
Product Type	Coaxial Adapter
Coaxial Cable Type	Foam Dielectric, Ultraflexible Foam Dielectric , Radiating Cable

MECHANICAL SPECIFICATIONS

Connector A	7-16 DIN Male Angle
Center Contact Connector A	Spring Bronze, silver plated
Outer Contact Connector A	Brass, silver plated
Connector B	7-16 DIN Female
Center Contact Connector B	Brass, silver plated
Outer Contact Connector B	Brass, silver plated
Body	copper alloy, nickel plated
Dielectric	PTFE
Gasket	Silicone rubber
Sealing class	IP68, connected

ELECTRICAL SPECIFICATIONS

Frequency Range	MHz	DC - 6000
VSWR, Return Loss	VSWR (dB)	0 - 1000 MHz: 1.04 (34.15) 1000 - 3000 MHz: 1.05 (32.25) 3000 - 6000 MHz: 1.08 (28.3)
Insertion Loss (Max)	dB	0.02
3rd Order IM Product @ 2x20 Watts	dBc	< -165

TEMPERATURE SPECIFICATIONS

Operation Temperature	°C (°F)	-45 to 85 (-49 to 185)
-----------------------	---------	------------------------

PACKAGING INFORMATION

Package Quantity	1
------------------	---

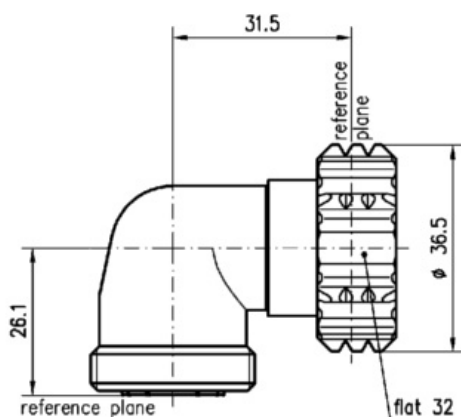



Coaxial Adapter 7-16 male, right angle - female

External Document Links	Notes