

Mini Mobile Mount for Antennas up to 2400 MHz

DESCRIPTION

- > Professional quality in an elegant and smooth design.
- > Wind tunnel optimized pyramidal shape.
- > Especially suited for roof-mounting.
- > Low installation depth.
- > Built-in bendable section for adjustment of the whip (tiltable 15° by hand).
- > Internal M5 thread whip-fastening system.
- > Total height of only 30 mm – satisfies the EC-directive 79/488/EEC.
- > Stainless steel mounting body.
- > Provided with FME-connection system – cable to be ordered separately.
- > Designed for the future – works up to and beyond 2400 MHz.
- > Whips available for communications systems in the frequency range 150 – 2400 MHz.



ORDERING

Type	Product No.
LX-Mount	130000371
1 m FME(f) to FME(f) cable	130000437
2 m FME(f) to FME(f) cable	130000447
3 m FME(f) to FME(f) cable	130000457
4 m FME(f) to FME(f) cable	130000466
5 m FME(f) to FME(f) cable	130000474
6 m FME(f) to FME(f) cable	130000483
4 m FME(f) to FME(f) cable, white	110000064
6 m FME(f) to FME(f) cable, white	110000066
12 m FME(f) to FME(f) cable, white	110000068
18 m FME(f) to FME(f) cable, white	110000069
FME(f)-FME(f) Connector Adaptor	130000583
FME(m)-P(m) (Prolongation) Connector Adaptor	130000565
FME(m)-N(m) Connector Adaptor	130000571
FME(m)-SMA(f) Connector Adaptor	130000578
FME(m)-BNC(m) Connector Adaptor	130000566
FME(m)-TNC(m) Connector Adaptor	130000569
FME(m)-UHF(m) Connector Adaptor	130000572
FME(m)-MiniUHF(m) Connector Adaptor	130000573
FME(m)-MiniUHF(m)(Elbow) Connector Adaptor	130000582
FME(m)-BNC(m)(Elbow) Connector Adaptor	130000580
FME(m)-TNC(m)(Elbow) Connector Adaptor	130000581
FME(m)-SMA(m) Connector Adaptor	130000577

SPECIFICATIONS

Electrical	
Frequency	150 - 2400 MHz
Application	Mount for mobile antennas
Mechanical	
Installation Diameter	31.5 mm / 1.24 in.
Build-In Depth	Active : 25 mm Passive : 11 mm
Connection(s)	FME-connection system (supplied without cable)
Materials	Stainless steel Cu-nite brass Environment-proof plastics
Installation Torque	3.5 Nm max.
Colour	Black
Whip Connection	M5 internal thread
Height	30 mm / 1.18 in.
Weight	0.022 kg / 0.05 lb
Mounting	18 mm dia. hole
Mounting Plate Thickness	Max. 2 mm

ADDITIONAL DATA

FME-SYSTEM ACCESSORIES

FME-CABLES	
TYPE	PRODUCT NO.
1 m FME(f)	130000437
2 m FME(f)	130000447
3 m FME(f)	130000457
4 m FME(f)	130000466
5 m FME(f)	130000474
6 m FME(f)	130000483
4 m FME-white(f)	110000064
6 m FME-white(f)	110000066
12 m FME-white(f)	110000068
18 m FME-white(f)	110000069

FME-CONNECTORS	
TYPE	PRODUCT NO.
FME(f)-FME(f)	130000583
FME(m)-P(m) (Prolongation)	130000565
FME(m)-N(m)	130000571
FME(m)-FSMA (Female-SMA)	130000578
FME(m)-BNC(m)	130000566
FME(m)-TNC(m)	130000569
FME(m)-UHF(m)	130000572
FME(m)-MUHF(m) (Mini-UHF)	130000573
FME(m)-EMUHF(m) (Elbow-MUHF)	130000582
FME(m)-EBNC(m) (Elbow-BNC)	130000580
FME(m)-ETNC(m) (Elbow-TNC)	130000581
FME(m)-SMA(m)	130000577

For further information about other types of FME-cables and FME-connectors, please compare the cable and connector data sheets under accessories in our catalogue.

INSTALLATION

The LX-mount is especially suited for roof-mounting. It is recommended to mount the antenna at the centre of the roof to ensure the best omnidirectional coverage. Mounting can take place in an 18 mm dia. hole with access from the outside only. A good contact surface on the inside of the car body must always be ensured, thus enabling the base plate to get in direct contact with the metal parts of the car, which is of utmost importance for proper performance of the antenna. When cleaning the car in car-washing machines, the whip should be removed. After wash, the whip is refitted and tightened lightly. The mount is equipped with a bendable section ($\pm 15^\circ$) to make it possible to adjust the antenna to an upright position.

1. INSTALLATION DIMENSIONS

LX-MOUNT

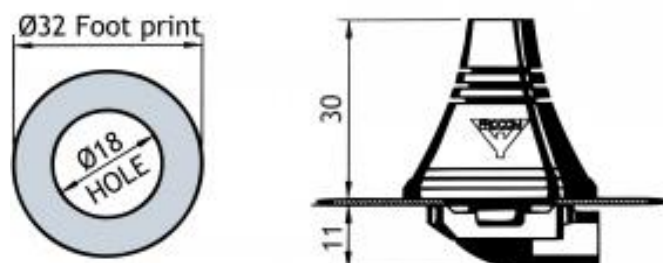

2. INSTALLATION STEPS

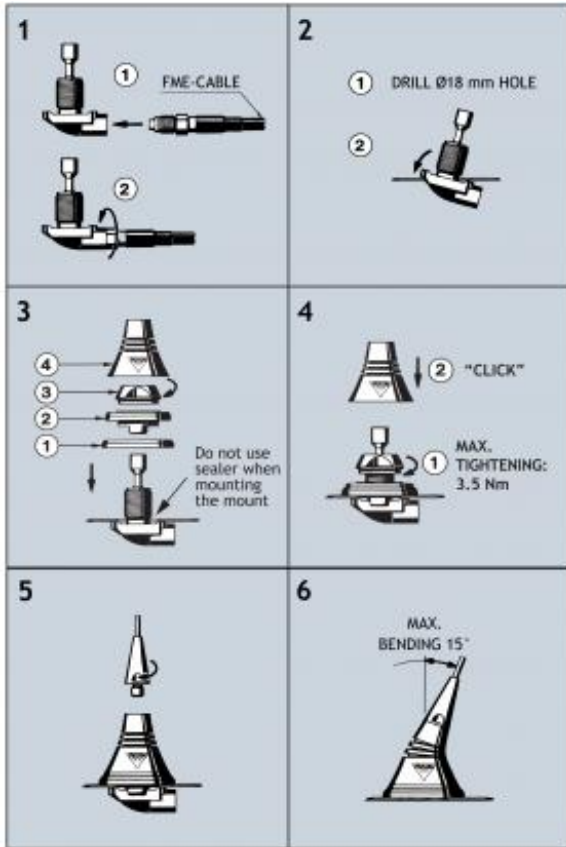

Do not use sealer on rubber gasket or other places.

PLEASE NOTE

When tightening the revolving nut (see picture 4), special care must be taken to keep the spanner in the correct position.

